

SPORTTREK

Travel Trailers & Toy Haulers

2018 Décor



Coffee

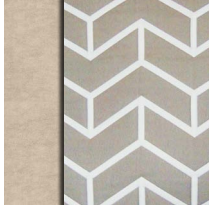

Latte



Living Room/Kitchen

- Seamless Countertops
- Built-In Radius Entertainment Center w/Shoe Cubby
- Bluetooth DVD/CD/MP3/AM/FM Stereo w/Remote
- Linoleum w/3-Year Warranty
- High Efficiency LED Lighting
- Residential Carpet
- Panoramic Opening Slideout Windows
- Skylight w/Shade
- 72" Slideout Height
- 82" Interior Height (most models)
- Mortise & Tenon Cabinet Doors
- Tilt-Out Utility Tray
- High-Rise Satin Nickel Faucet w/ Sprayer
- 50/50 Undermount Stainless Steel Sink
- Safe-Tek® Box w/USB Charger
- Cutting Board Sink Cover
- Full-Extension Ball Bearing Drawer Guides
- Comfort by Design® Grand Dinette
- Comfort by Design® Sofa
- Flush-Mount Interior Speakers
- Overhead Cabinets in Slideout

Appliances

- Microwave w/Turntable
- 6.3 CU FT Refrigerator
- 3-Burner Stovetop w/Oven
- Vented Range Hood w/Light
- Coleman® Whisper A/C
- 6 GAL LP/Electric DSI Quick Recovery Water Heater

Bath

- Foot-Flush Porcelain Toilet
- Multi-Shelf Shower or Tub
- Designer Shower Curtain (VBF)
- Mirrored Medicine Cabinet

Bedroom

- Designer Padded Headboard
- 60" x 80" Sleep Tight® Mattress
- Reversible Residential Quilted Comforter
- Teddy Bear® Bunk Mattress(s)
- Solid Wood Nightstands
- Overhead Storage Cabinets
- Full Length Closets w/Easy Access Nightstands w/USB Port (110 outlet)
- (2) Gas Struts for large Under-Bed Storage
- Solid Wood Privacy Door(s) (most models)
- TV & Satellite Connections
- Hard Valances
- Nightshades

Exterior/Construction Features

- 4-Sided Ivory Exterior Fiberglass
- Diamond Plate Rock Guard
- EZ Access® LP Tank Cover
- EZ Exchange® (2) 20 LB LP Tanks w/ Auto Changeover
- Large Pass-Thru Baggage Doors (cooler-sized)
- Wide-Trek® Axles
- Keyed Alike Key System
- Self-Adjusting Brakes
- Triple Entry Steps w/LED Stairwell Light
- Under Shield® Heated & Enclosed Underbelly
- BAL® E-Coated & Epoxy-Painted Huck Bolted Frame
- Deep Slides w/Colored Slideout Ends
- Exterior Shower w/Hot & Cold Water
- Tinted Safety Glass Windows
- Hitch Light
- (4) Ground Effect Blue LED Lights
- Digital Antenna Receiver

- Magnetic Baggage Door Catches
- Large Assist Grab Handle
- Cable/Satellite Connection (2 locations)
- (4) Secure Stance® Angled Stabilizer Jacks
- 5/8" Tongue & Groove Plywood Floor
- Walkable Roof
- (2) Marine-Grade Exterior Speakers
- Alpha Superflex® Roof Material
- Gutter w/Downspouts
- Gutters above Slideouts
- Extra-Long Awnings
- Pre-Wired Solar
- Pre-Wired Backup Camera
- 15" Radial Tires

Options

- Table/Chairs IPO Dinette
- 3/4 Front Cap w/Upgraded Graphics
- Multi-Directional LED Lighted Power Awning
- Swing Away Bumper Mount Grill
- Lighted Power Tongue Jack
- Fireplace – 5,500 BTU Electric Heat
- Theater Seating (most models)
- Flip-Up Bike Rack/Cargo Tray
- Cotton Cloud Mattress
- 15" Aluminum Wheels (4)
- Backup/Observation Camera
- 8 CU FT Refrigerator
- Tri-Fold Sofa
- 15,000 BTU A/C
- 50 AMP Service w/2nd A/C Prep
- 2nd A/C

Trail Package

- Spare Tire, Carrier & Cover
- Ladder
- Black Tank Flush

Entertainment Package

- 39" HD LED ROKU-Ready TV w/USB Port & Swing-Arm Bracket

Explorer Package (Option)

- Aluminum Triple Entry Step
- Friction Hinge Door
- Interior Entry Door Motion Light
- Pass Thru – Motion Light
- Mountain Walnut Interior Wood
- Stainless Steel Appliances
- Cargo Tray/Bike Rack
- Multi-Directional LED Power Awning
- High Polished Aluminum Rims

SportTrek Toy Hauler Packages & Options

Toy Hauler Package

- Spare Tire/Carrier
- Ramp & Transition Extensions
- Security Light
- Black Tank Flush
- Toy Lok®

Entertainment Package

- 39" LED ROKU-Ready TV w/Swing-Arm Bracket (32" LED TV in 190VTH)

Toy Hauler Options

- Fuel Tank w/Pump Station
- High-Polish Aluminum Rims
- Power Bed (in garage area)
- (2) Power Beds in Garage
- Seat-N-Sleep in Garage
- 15,000 BTU A/C
- Multi-Directional LED Lighted Power Awning
- 50 AMP Service w/2nd A/C Prep
- Retractable Screen Cargo Door
- Lighted Power Tongue Jack
- 2nd A/C

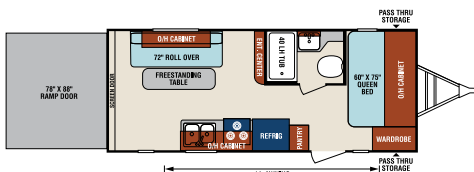

ST190VTH Toy Hauler

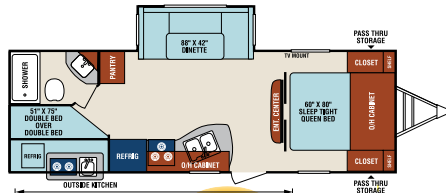

ST251VBH NEW

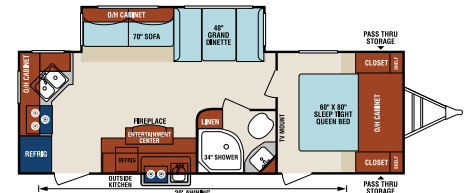

ST251VRK



ST252VRD NEW

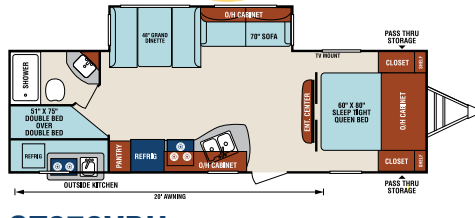

ST270VBH

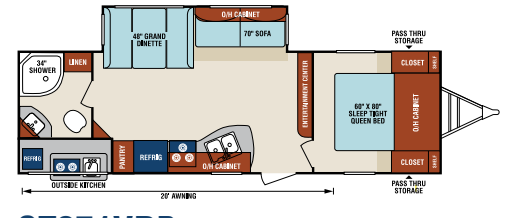

ST271VRB

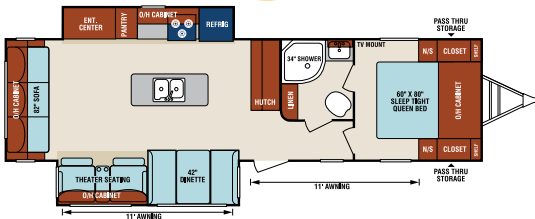

ST290VIK

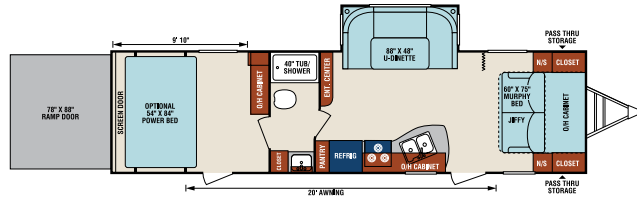

ST302VTH Toy Hauler

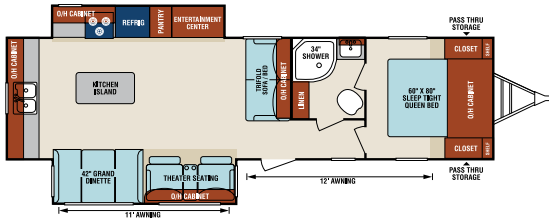

ST312VRK

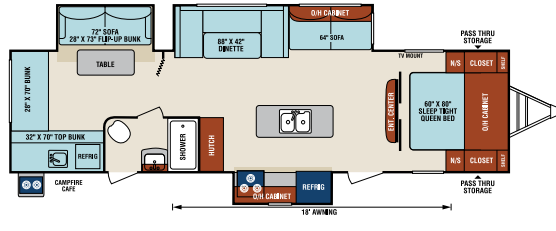

ST320VIK

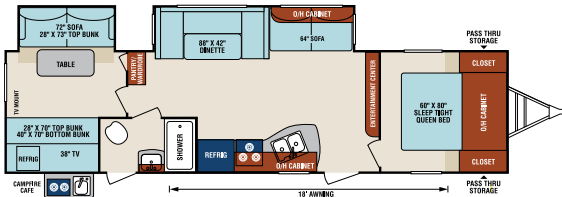

ST322VBH

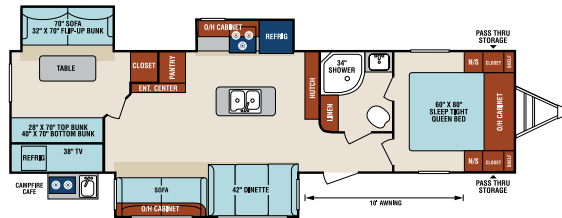

ST327VIK

Travel Trailers	ST190VTH	ST251VBH	ST251VRK	ST252VRD	ST270VBH	ST271VRB	ST290VIK	ST302VTH	ST312VRK	ST320VIK	ST322VBH	ST327VIK
UVW (Unloaded Vehicle Weight)*	4,450	5,190	5,940	5,940	5,460	6,180	7,000	6,480	7,260	7,250	7,130	7,750
Dry Hitch Weight*	680	650	630	680	660	630	770	1,000	740	860	710	850
Dry Axle Weight*	3,770	4,540	5,310	5,260	4,800	5,550	6,230	5,480	6,520	6,390	6,420	6,900
NCC (Net Carrying Capacity)	2,550	1,310	1,060	1,060	1,340	2,120	1,300	2,120	1,040	1,350	1,170	1,050
GVWR	7,000	7,000	7,000	7,000	7,000	8,300	8,300	8,600	8,300	8,600	8,600	9,600
Interior Height	82"	82"	82"	82"	82"	82"	82"	82"	82"	82"	82"	82"
Exterior Height with A/C	10' 9"	10' 9"	11' 2"	11' 2"	10' 7"	11' 4"	11' 1"	12' 6"	11' 4"	11' 1"	11' 2"	11' 8"
Exterior Width	96"	96"	96"	96"	96"	96"	96"	96"	96"	96"	96"	96"
Exterior Length	23' 10"	28' 7"	28' 7"	29' 5"	30' 8"	30' 10"	34' 8"	34' 4"	35' 1"	35' 11"	35' 11"	36' 4"
Refrigerator (Cubic Feet)	6	6	6	6	6	6	6	6	6	6	6	6
Water Heater Cap. (Gal. Gas w/DSI)	6	6	6	6	6	6	6	6	6	6	6	6
Fresh Water Capacity (Gallon)	40	40	40	40	40	40	40	40	40	40	40	40
Black Water Capacity (Gallon)	32	32	32	32	32	32	32	32	32	32	32	32
Gray Water Capacity (Gallon)	32	32	64	32	32	32	32	32	64	32	32	32
LP Gas Capacity (Lbs.)	40	40	40	40	40	40	40	40	40	40	40	40
Furnace BTUs (1,000s)	20	20	30	30	30	30	30	30	30	30	30	30
Tire Size	15"	15"	15"	15"	15"	15"	15"	15"	15"	15"	15"	15"
Awning	14'	18'	20'	18'	20'	20'	11'/11'	20'	11'/12'	18'	18'	10'/10'

*This weight reflects the rolling average unit weight for each model. Your trailer weight will vary according to optional equipment.



985 N 900 W • Shipshewana, IN 46565
www.venture-rv.com

Due to continual research and advances, manufacturer reserves the right to change specifications, design, price and equipment without notice, and assumes no responsibility for any error in this literature. Some items shown are not included as standard or optional equipment. ©2017 Venture | 9/1/17 | 15M